

nortik fold

Recreational kayak



fold

ASSEMBLY INSTRUCTIONS

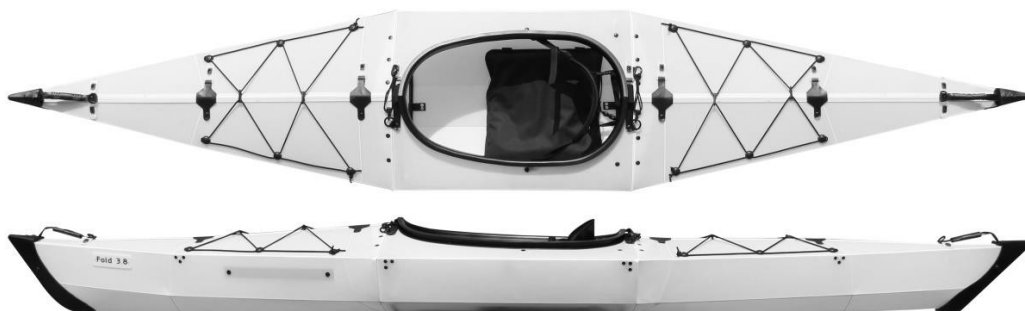

Assembly instructions for the Nortik Fold

Dear Customer,

You have purchased a **Nortik Fold**, an innovative recreational origami folding kayak that is unique in its kind.

We have made the assembly instructions very detailed, and every step is illustrated. However, you will find that after 2–3 assemblies, you will no longer need the instructions at all.

Experience shows that the first few assemblies are somewhat more difficult than later ones, once you have become familiar with the system. The assembly system of **the nortik fold** is extremely simple, and after just a few assemblies, you will need no more than 5–10 minutes.

Please take plenty of time for the initial setup and follow the instructions carefully. Even though this requires a bit of discipline, it helps you learn the setup system properly. Please **read through the instructions carefully first, and then** start the setup **again** step by step using the instructions. You will always find the explanation for the images on the left-hand side on the right-hand page.

Every boat is assembled and inspected before it leaves the factory. However, if you believe there is a problem with your boat, please contact us.

If you have any questions about the product, assembly, or accessories, your dealer will certainly be happy to assist you. Otherwise, you are also welcome to contact us directly—as the manufacturer.

(Phone: +49 (0) 731 - 4007675; Email: kontakt@faltboot.de).

- Please also watch the assembly and disassembly videos online. You can find them at www.faltboot.de or at www.youtube.de under the keyword “nortik fold assembly”

Important notes before you begin:

Every **nortik fold** is handmade. The **nortik fold** is a folding boat designed for recreational use, and we ask that you handle it with care. Always get into the boat only after it is on the water, and get out before the boat touches the bottom. Avoid touching the bottom even while paddling.

Take special care to handle the **caps at the bow and stern** gently! Riding onto gravel, pulling the boat onto the shore, and similar actions damage the caps and can cause them to break or tear. Therefore, avoid bottom contact, especially with the caps.

Avoid carrying the boat by the handles. Always carry folding boats from below at the keel to avoid localized stress.

Please note in particular that closing the ridge profile becomes easier each time as the system “wears in” a bit.

1) Parts Overview

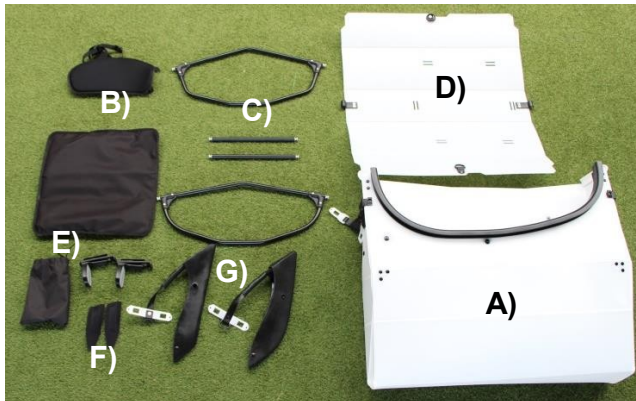

The following assemblies and parts are included in the scope of delivery:

- A) 1x Panel
- B) 1x seat and backrest
- C) 2x frames
(the taller one is the bow frame)
+ 2x rods
- D) 1x cockpit panel
- E) 2x footrests
- F) 2x neoprene covers
- G) 2x end caps (bow and stern)

2) Assembly



Loosen the side straps on the panel.

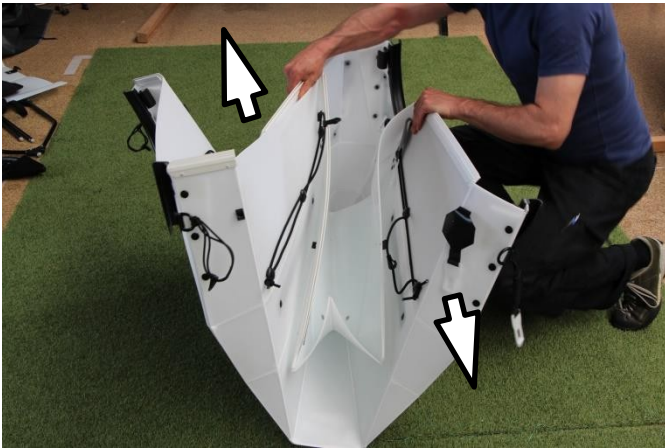

Carefully fold the panel open.

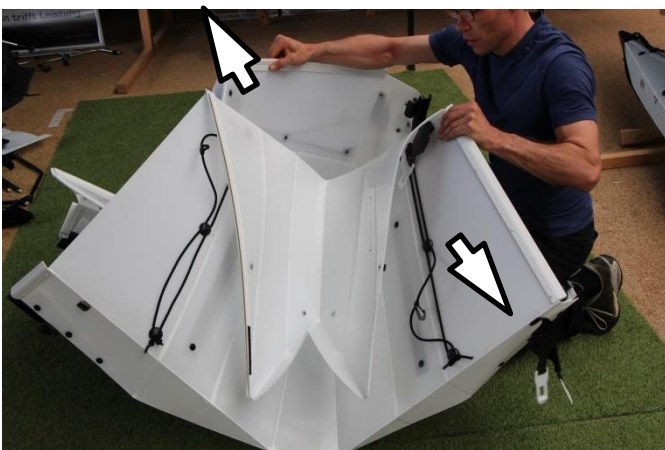

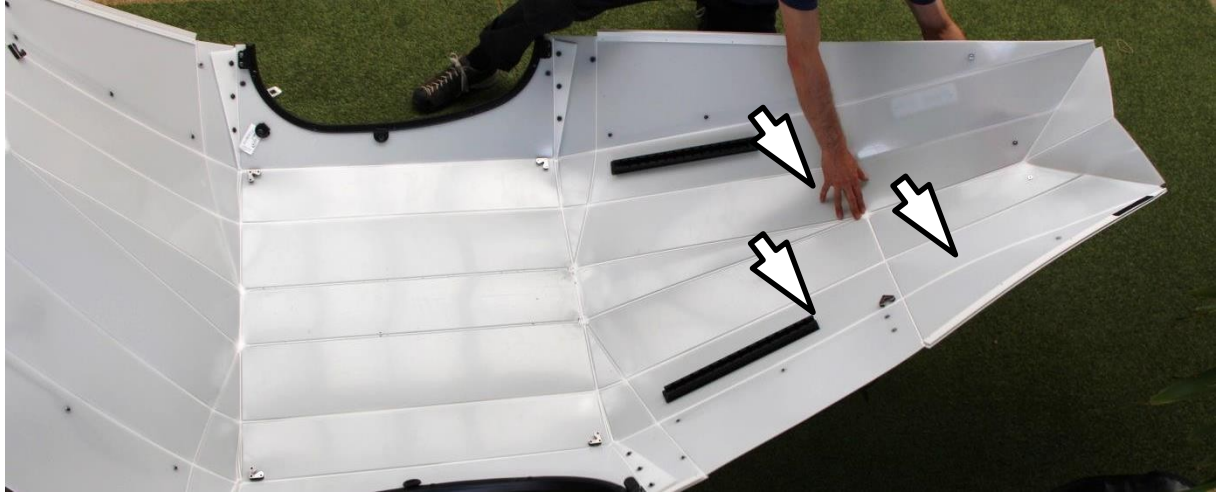

! Press all inward-facing bulges outward.



Please take the two neoprene covers...

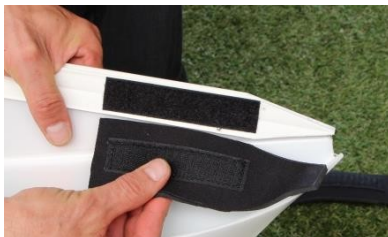

...and attach them to the Velcro strips provided on the inside of the bow and stern.



Now pull the two sides toward each other and connect the deck lines only with the clips that are closer to the cockpit.

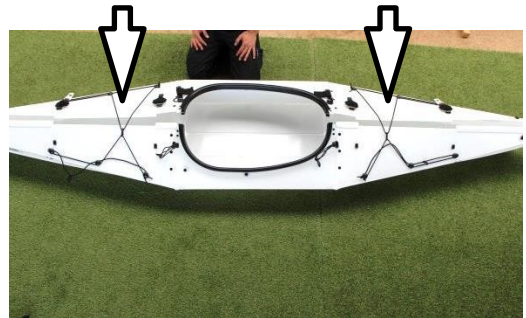

Then take the two short rods. These are inserted at the bow and stern. The rods are identical.



Reach into the bow (or stern) and insert the two rods.

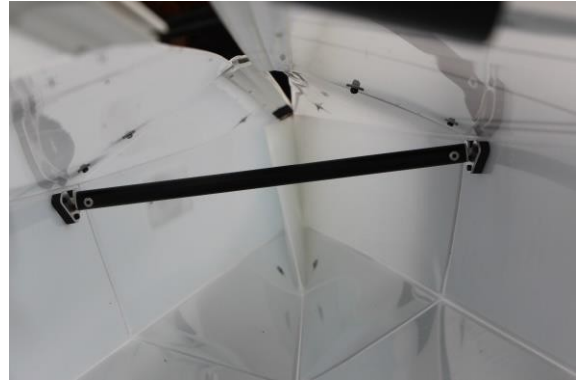

Interior view

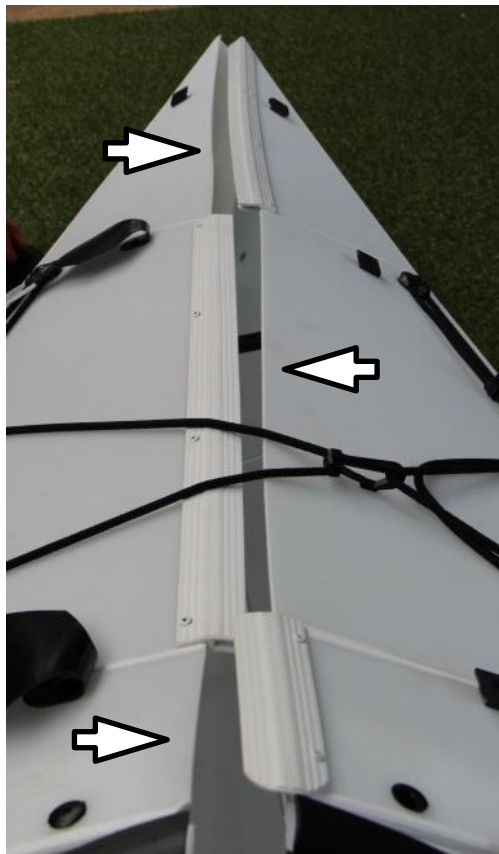

Once the two bow and stern rods are in place, the next step is to close the ridge profile.

On the left, you can see how the profile is generally slid into place.

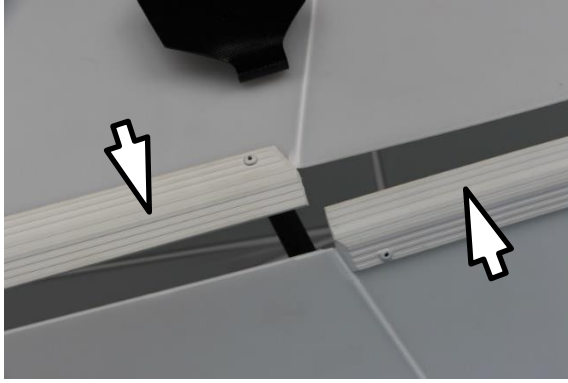

As you do this, always push both sides toward each other so that one side engages with the profile of the other side. This process takes a little practice at first, but after the first few assemblies, it will become much faster and easier for you.



As a general rule, it's easiest to work from the cockpit toward the bow and stern. In other words, first slide the short section behind (in front of) the cockpit into place, followed by the next section.



Once you have threaded the profile together, secure it immediately with the fastener, starting with the **second (!)** one from the cockpit

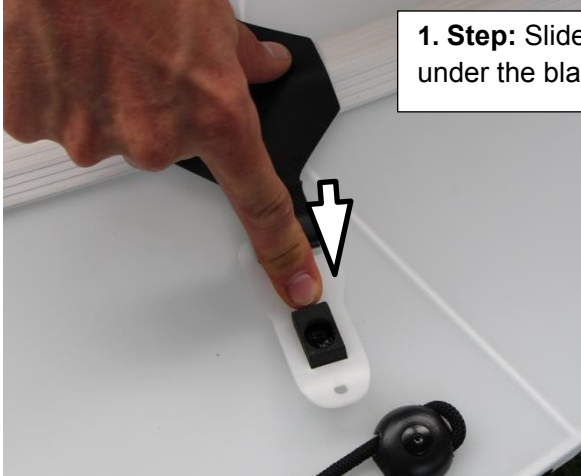

1. Step: Slide the fastener from behind under the black clip

Please be sure to follow these basic instructions when closing the clips:

First, slide the white clip as far as possible from the back under the black fastener attached to the deck.

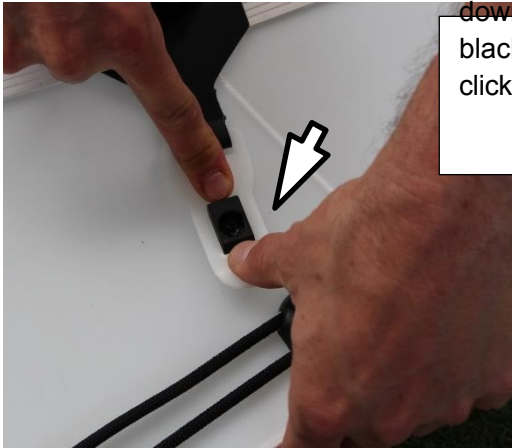

2. Step: Press the clip down in front of the black fastener until it clicks into place

Only then can you press the white clip down at the front until it clicks into place.



Then thread the rest of the closure profile together and immediately connect the deck lines completely.



Then close the next clip.



Finally, close the first clip from the cockpit.
To do this, please rotate the D-ring away from the cockpit to create enough space for the clip. This clip is the hardest to close because there is the most tension here.

With a little practice, this will be easy for you too.

If you can't manage to close the fastener at this point, you can also install the two cockpit frames first (see the following steps) and then try again.

The better method is the one described here—but some people find it easier the other way around. Give it a try!



First, place the strap of the fastener clip under the profile.

Here, it is **particularly important** that you slide the clip as far as possible from the back under the black fastener and only then press the clip down at the front, see the following two pictures!



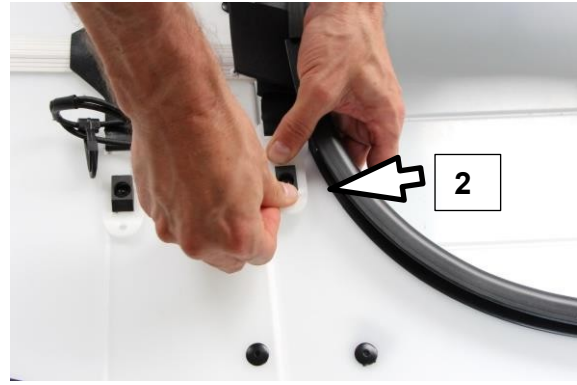
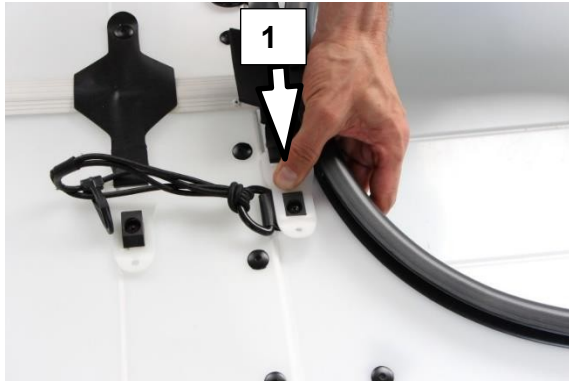

The locking profiles are now threaded in, all clips on the deck (three each toward the stern and bow) are closed, and the deck lines are connected to each other.

Bow/Stern orientation

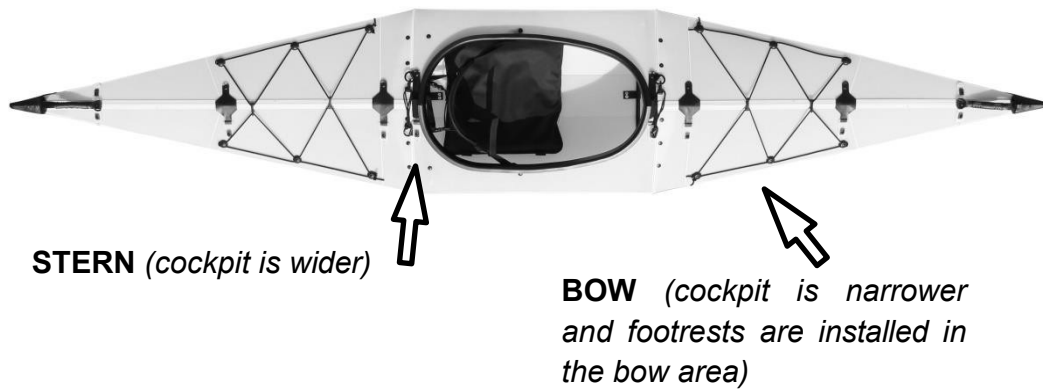

3) Installing the cockpit frames



Stern frame
(flatter)

Bow frame
(higher)

Specifications for the frames:

The higher frame is installed toward the bow as viewed from the cockpit, and the flatter one toward the stern.



First, take the bow frame (higher) in hand. You are already familiar with the side mounts from installing the struts in the bow and stern.

The upper part of the frame is pushed into the boat and will later engage from the inside with the brackets you see at the top of the cockpit:



So position the frame at an angle...



...clip it into the brackets on both sides...



...turn the upper side from the inside toward the cockpit so that the frame engages with the brackets at the top from inside the boat...



...and at the same time, slide the lower frame toward the bow.



The stern frame (the flatter frame) is installed in the same way. Insert it into the brackets on both sides, and the upper end of the frame will then engage with the brackets from the inside.

The frames also create a bit of tension as you insert them. Especially with the stern frame, you may find it easier if you gently press the sides of the boat together to position the frame properly in the side brackets.



Then wrap the neoprene attached to the fastening clips in front of and behind the cockpit under the cockpit edge (coaming).

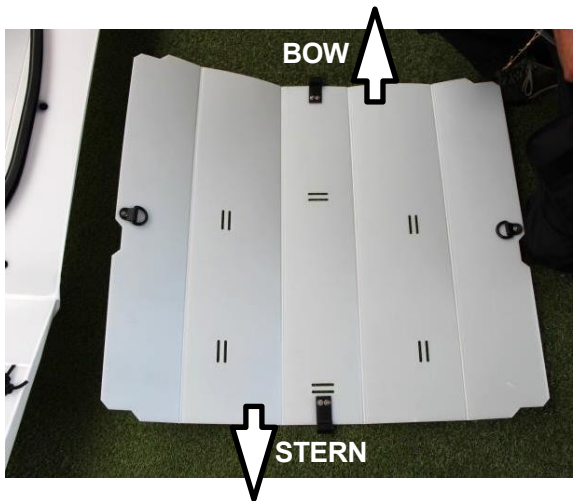

Next, install the cockpit panel, seat, and backrest. Please refer to the image on the left to see how the plate is positioned.



First, thread the seat through the slots on the cockpit plate and secure it with Velcro. The D-rings will later be on the left and right sides of the kayak, and the backrest will be secured to them.



Then take the panel, “roll” it up slightly at the creases, and place it in the cockpit.

Press the sides into the boat so that the panel is positioned exactly in the cockpit area.



Make sure that the two fittings on the panel grip around the cockpit frames.



Here is a close-up view



Then hook the clips in front of and behind the cockpit into the D-rings (the clips with the round rubber bands that hold the kayak together even when folded).



Then install the backrest by wrapping the center straps around the cockpit frame and closing the clips.



Then thread the side straps through the D-ring on the side and tighten/position the backrest as desired.





Next, take the bow and stern caps.

The bow cover is slightly more rounded, **while** the stern cover is slimmer. **Be careful not to mix up the covers!**



We'll demonstrate the installation using the stern cap. Please follow the same procedure for the bow.

The cap has two metal tensioning levers and a mounting clip (with a D-ring) for the upper hull. Open the tensioning levers.



First, place the cap on the stern, then slide it as far as possible onto the boat.



Next, take one of the tension levers and position the notch exactly over the corresponding part on the kayak.

Then push the lever forward. This creates some tension.



Slide the tension lever under the cover cap so that the button on the lever is inserted into the designated hole on the cap.



Repeat this on both sides!

4) Installing the footrests



First, pull the locking pin toward you.



Slide the footrest onto the rail permanently installed in the boat



The footrest is easiest to move if you press the entire footrest slightly diagonally toward the rail and then slide it!



Slide the locking pin forward under the footrest at the desired position.

The Fold is now fully assembled

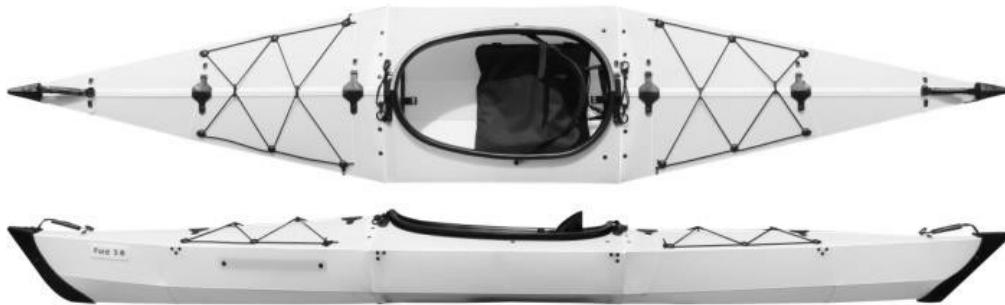

5) Disassembly



The “most complicated” part is folding the panel correctly. Only by folding it correctly can you prevent potential damage! Please read this section very carefully and pay close attention to the pictures!

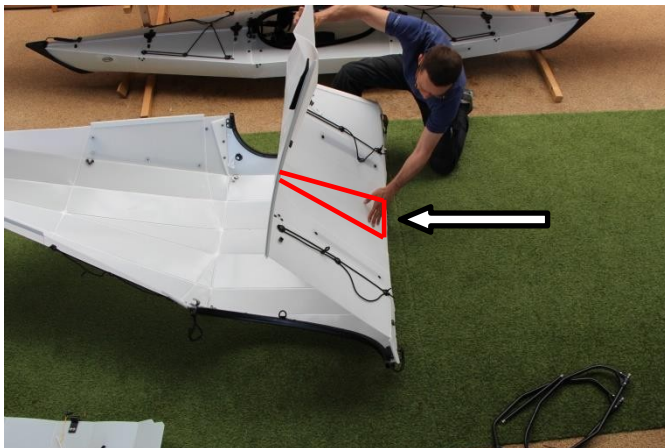

After removing all the frames, the cockpit panel, seat, backrest, and footrests, stand the panel upright on one side and press the fold line marked on the left inward (toward the inside of the boat). The fold line is located in the second segment (from the top) at the center.



It is essential that this very center part of the second segment is pressed inward. This is necessary to be able to fold the panel at all.

Then fold the first segment all the way over.



Proceed in the same way on the other side. Lift the panel, fold the upper part slightly over ...



...and press the middle segment inward.

It is crucial that the area described and marked above is pressed inward on both sides. Otherwise, folding is not possible, and continuing the process will cause damage.

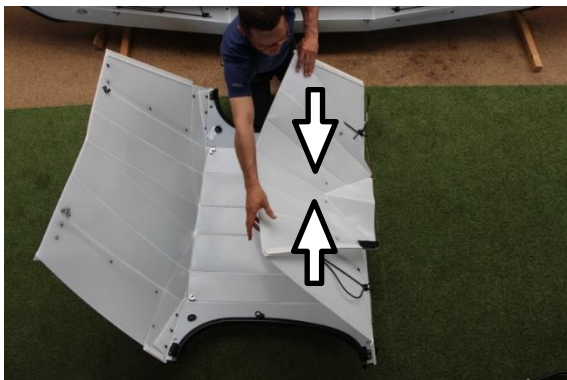

Then reach with one hand to the other side and fold one half together





Proceed in the same way on the other half of the boat

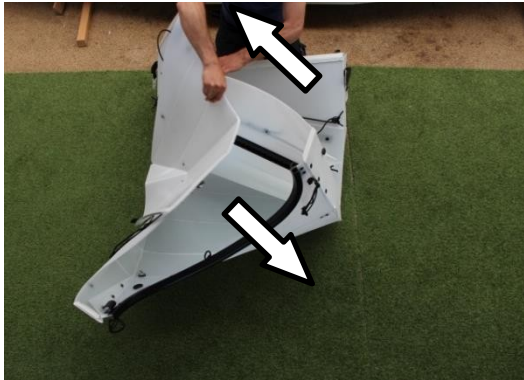

The two sides are then slid into each other side by side. As you do this, push one side slightly away from the other and slide one side “behind” or “in front of” the other, as shown on the left and below.



Slide the two halves together—past each other.

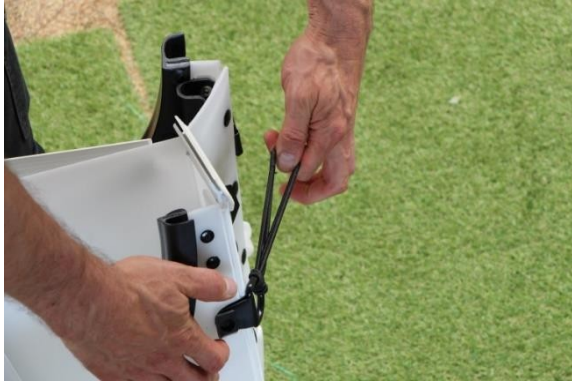

Then close the fastener on the sides.



Pack the folded item along with the other parts into the packing bag.

6) Important Notes

Every *nortik fold* is handmade. The *nortik fold* is a folding boat designed for recreational use, and we ask that you handle it with care. Always get into the boat only after it is on the water, and get out before the boat touches the bottom. Avoid touching the bottom even while paddling.

Please note in particular that sliding the deck closure together becomes easier each time as the system “wears in” a bit.

STORAGE

It is best to store the fold in its packing bag, unassembled, in a dry place that is not exposed to extreme heat or cold. If storing the boat in its assembled state, it is essential to ensure that it lies flat and is never stored with localized pressure in boat stands or similar supports. This will damage the material.

SAFETY

Please read the following instructions carefully, be aware of the risks associated with water sports, and take the advice seriously!

Prevent risks before they occur:

- Always wear a life jacket
- Only paddle in conditions and areas that match your skill level
- Do not paddle alone; always paddle in groups
- Be aware of rapidly changing weather conditions
- Always paddle close to shore
- Always bring a map or navigation device
- Do not paddle after dark, and always carry a flashlight
- Always bring enough water and food
- Make sure your paddling technique meets the requirements
- Practice how to prevent capsizing in a paddleboat
- Learn and master how to empty a kayak that has filled with water
- Learn and master how to re-enter a kayak in the event of a capsize
- Bring a cell phone and store it within easy reach in a waterproof bag
- Be aware that any part of your kayak or paddle can break.
Be prepared for such a dangerous situation.
- Practice and learn these skills regularly with the help of an experienced kayak instructor
- Make sure you carry enough flotation devices (e.g., waterproof bags, tip bags, etc.) with you!



7) Other useful accessories



Boat sock

The boat sock is an accessory that many people wouldn't want to do without. You hang it in the cockpit and then sit, so to speak, inside a sock. This prevents dirt and water from getting into the boat. Not only does this protect the boat itself, but it also provides greater safety in the event of a capsize. A clever idea.



Thermal-PU spray skirt

The elastic and lightweight Thermal-PU material provides maximum water protection, a secure grip on the coaming, and packs down small.

Hatch Cover

The practical hatch cover protects your boat from spray, dirt, and small animals. Material: Nylon.



Paddle

nortik paddles, two- or four-piece. Available in fiberglass or with a carbon shaft.



You can also find more information about this and other products, as well as where to buy them and downloads, at any time at:

FALTBOOT.DE