

nortik kayak sail

Quick Guide for Installation on Fixed-Hull Boats



Dear Customer,

The installation of the sailing system consists of two parts. First—if your boat does not have the necessary pre-installed equipment, or only has some of it—the instructions focus on the required “hardware” on the boat (mast mount, cleats, rope clamps). In a second step, the installation of the sail itself is explained.

Please note the following:

! This brief description also includes instructions for installation on folding boats. Please also use these as a guide regarding the spacing and installation points for the “hardware.” There are a wide variety of different boat shapes and types. It is impossible to provide a separate description for every single variant.

As is also the case for folding boats, the positioning options are recommendations. Adjust the details to fit your own boat. Many kayaks already have fittings and installations that you can use for the Nortik Kayak Sail.

The brief installation instructions for rigid boats focus on the description of the scope of delivery, the assignment of individual components, and notes on their installation.

Please take the time to carefully read through both these brief installation instructions for rigid boats and the installation guide for folding boats before you begin.

If you have any questions, your dealer will be happy to assist you. Otherwise, you are also welcome to contact us—the manufacturer—directly. (Phone: +49 (0) 731 - 4007675; email: kontakt@faltboot.de).

1) Scope of Delivery

The scope of delivery is divided into two parts: the installation kit and the sail itself. The screws, etc., are marine-grade (V4A stainless steel) and are always included with the respective parts as shown!

Installation kit for fixed boats

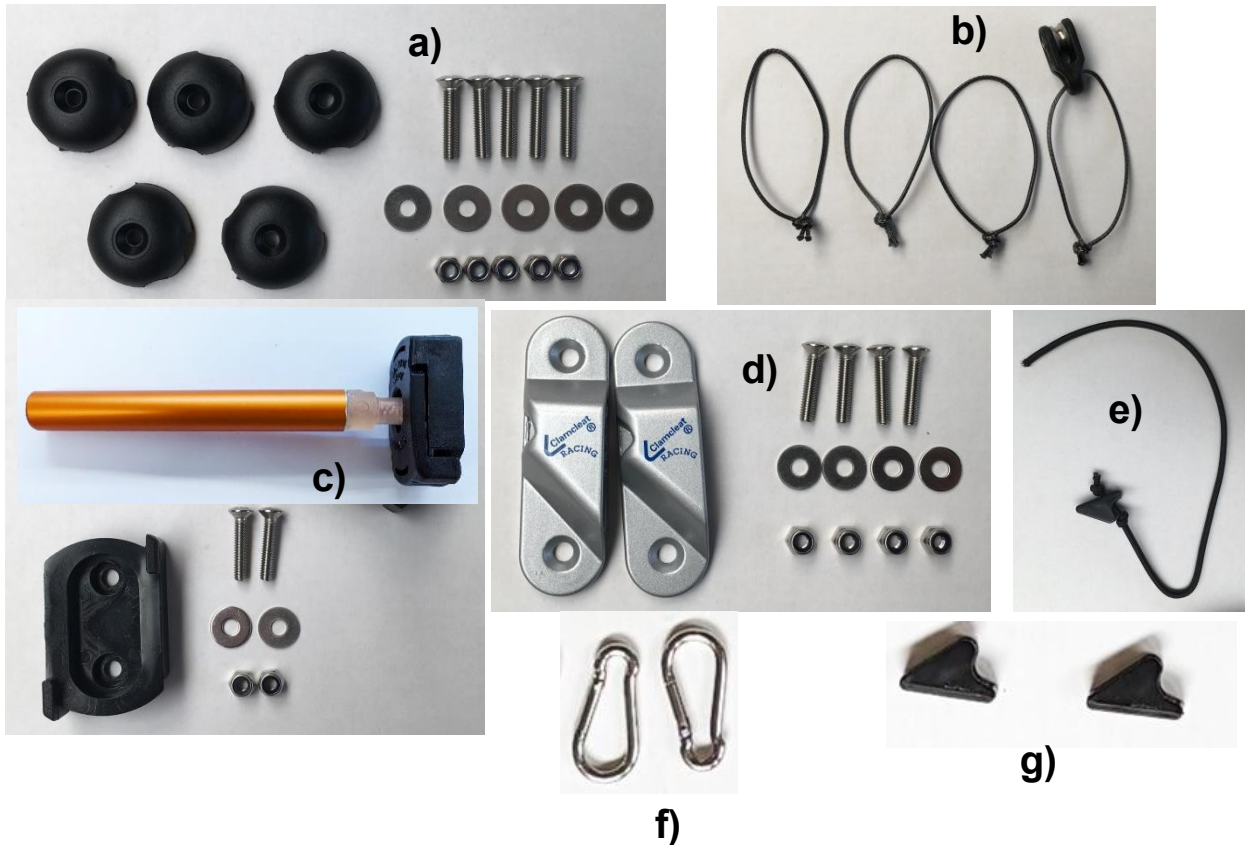

- a) 5 round buttons, including 5 M5 screws, 5 5.3 mm washers, and 5 M5 self-locking nuts
- b) 4 x slings, 1 of which includes a pulley
- c) Mast mount (consisting of a mast mounting plate, a locking plate, and the mount itself (with mast adapter), including 2 M4 screws, 2 x 4.3 mm washers, and 2 x M4 self-locking nuts
- d) 2 x Clam-Cleat rope clamps, including 4 x M4 screws, 4 x 4.3 mm washers, and 4 x M4 self-locking nuts
- e) Sail attachment for the sail lying on the deck (one of the round buttons is used for this)
- f) 2 x carabiners (these are attached to the two loops (2))
- g) 2 x cord tensioners (for tensioning the sail at the two loops (2))

Nortik Kayak Sail: Tension lines, 2-piece mast, sailcloth



2) Instructions for installing the necessary components on the boat

These steps only need to be done once. The installed mounts/brackets will then remain securely attached to the boat. Many kayaks already have mounts/brackets that can also be used for the Nortik Kayak Sail. Please check this first.

The mounts/brackets are permanently attached to the kayak using screws. If in doubt, ask your kayak manufacturer about attaching parts to your kayak. Installation on rigid boats is intended for experienced DIYers who are comfortable drilling and screwing into their kayak. The drilling and screwing process itself is not described here. If you are unsure or have no experience in this regard, please research the topic thoroughly or contact a professional for installation.

General layout of the parts in a schematic diagram:

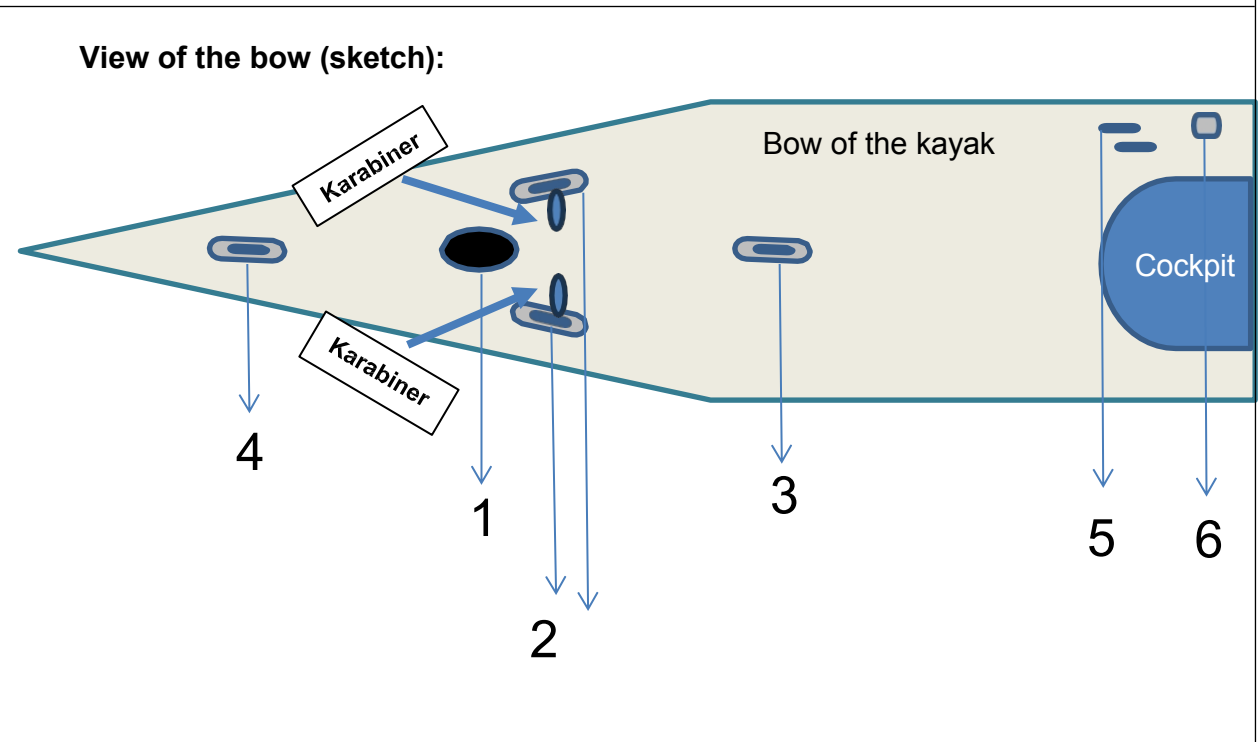

Here are the positions again in a model view:

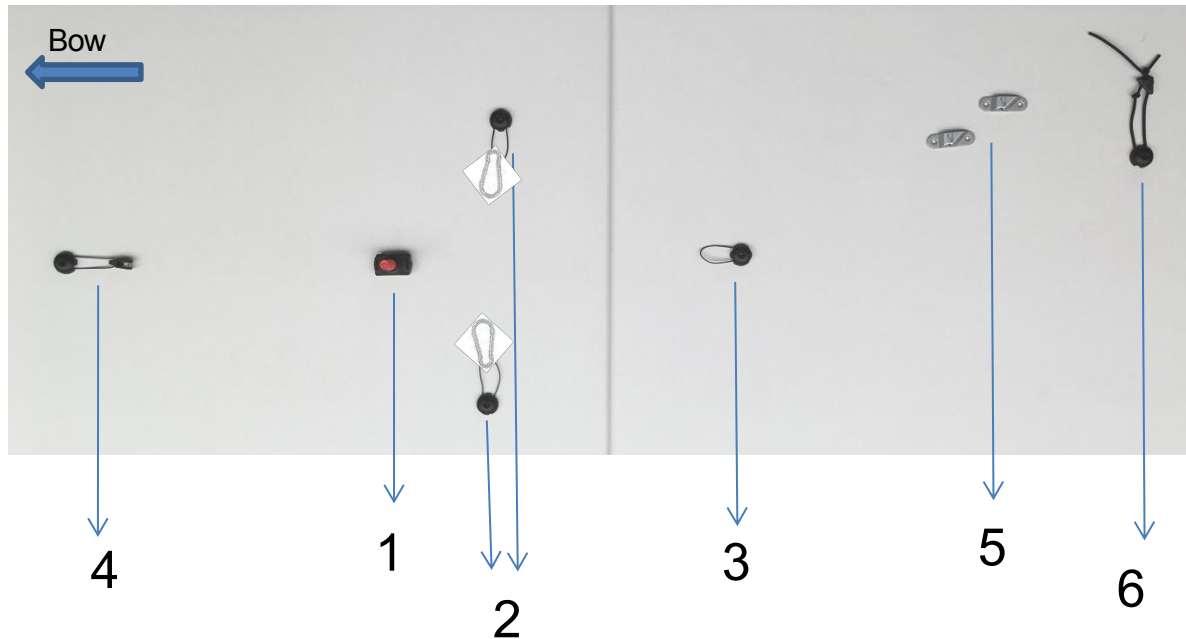

- 1 **Mast mount**
- 2 **2 x round knobs with loops and carabiners** (this is where the mast's side guy lines are attached)
- 3 **1 x round knob with loop**. The ropes will later be pulled through here toward the cockpit
- 4 **1 x round knob with loop and pulley**. A rope also runs through here.
- 5 **2 x "Clam-Cleat" rope clamps** (use these to secure the two ropes of the sail)
- 6 **1 x round knob with sail attachment**, for when the sail is on deck

The position where the D-rings and the bracket are to be attached varies depending on the boat model. Please refer to the enclosed assembly instructions for folding boats to get a sense of the correct positioning for your specific boat. There are countless variations and possibilities. However, always follow the basic alignment as shown in the sketch above.

Round buttons

Before installing the round buttons on the boat, please insert the loops into the four round buttons:



Press the knot firmly into the notch so that it no longer protrudes. A total of 3 round buttons with loops are installed at positions 2 and 3.

Be sure to install the loop with the pulley at position 4 (see diagram)!



At position 6, attach a round knob to secure the sail attachment for the sail lying on deck.



The round buttons are each installed with an M5 screw, a 5.3 mm washer, and an M5 self-locking nut.

Mast mount

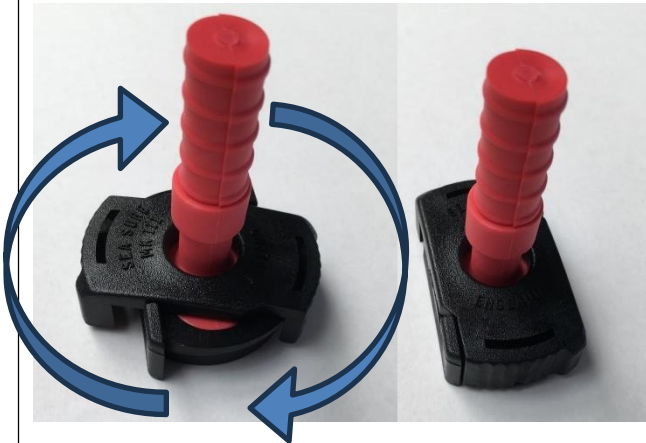

The mast mount (position 1 in the diagram) consists of three parts: a mast mounting plate, a locking plate, and the mount itself (with mast mount).

Only the mast mounting plate is permanently installed on the boat. To do this, please use 2 x M4 screws, 2 x 4.3 mm washers, and 2 x M4 self-locking nuts.

The transducer itself can be removed and reattached at any time using the retaining plate; see left (fig. without transducer tube)



"Clam Cleat" rope

clamp facing the stern

Toward the bow



Make sure to install the rope clamps so that the rope can be released later during operation by pulling it firmly backward. In other words: The rope is secured by clamping it toward the bow! The "teeth" of the clamp point toward the bow, as shown on the left. Choose the position of the rope clamps so that they are easily accessible from the cockpit!

Each of the two rope clamps is installed using 2 x M4 screws, 2 x 4.3 mm washers, and 2 x M4 self-locking nuts.

The Sail



Your sail consists of the sailcloth itself, the two-piece mast, and the attachment lines.



Please spread out the sailcloth and assemble the mast. The end of the thinner mast section with the plug at the tip points upward.



Then slide the mast through the plastic clamp and into the hem of the sailcloth

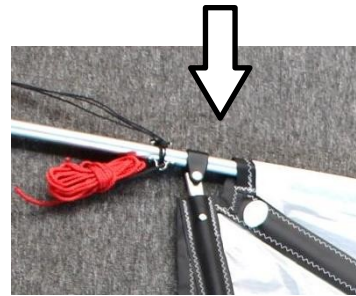

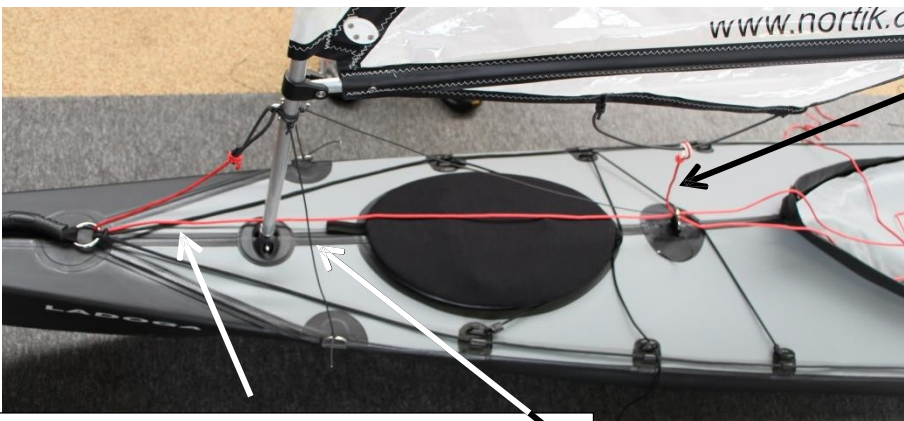

The basic setup—shown here on a folding kayak—looks like this:



The sheet, which is attached to the sail and runs all the way to the cockpit. You use this sheet **to control** the sail.

A guy line attached to the elastic cord. This runs through the front D-ring and then back toward the cockpit. This is used to **pull** the sail **up** from the cockpit.

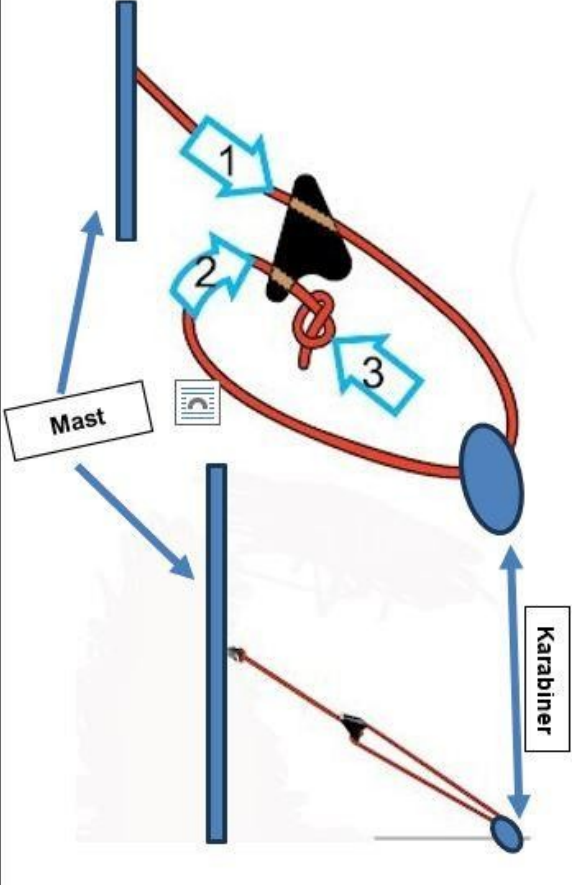
Side guy lines, each attached to the side-mounted D-rings using the cord tensioners and carabiners (the arrow shows only the right one)

	<p>Now the sail is tensioned:</p>
	<p>First, attach the two included carabiners to the two side loops.</p>
	<p>Instructions for cord tensioners:</p> <p>The diagram on the left explains in three steps how to mount the two included cord tensioners on the guy lines.</p> <p>Once the line tensioners are attached to the guy lines, you can tighten the sail by pulling each line tensioner toward the mast. The result is shown in the image below (here: scubi XL).</p> <p>Pull each line tensioner toward the carabiner to release the guy lines. By removing the guy lines from the carabiners, you can easily take your sail off the boat once your paddling trip is over.</p> 

Please also refer to the enclosed assembly instructions for folding boats when setting up the sail. There you will find an explanation of the basic procedure.

General and safety-related information:

Always wear a life jacket when you are on the water in your kayak! Be aware of sudden changes in weather conditions.

The use of the sail is recommended only for experienced paddlers and sailors.

Do not underestimate the forces acting on your boat in windy conditions and their impact on handling. If necessary, seek instruction or training from experienced sailors, approach the subject cautiously, and practice in safe, supervised, and secure areas.

A sailing license is not required per se, but be sure to check before using the sail whether it is permitted without restrictions at your planned location or if there are any regional restrictions!



For more information about this and other products, as well as where to buy them and downloads can also be found at any time at:

FALTBOOT.DE